

Marlow

Marlow has the most models for a single unit within the Pemberton range. There are two 12ft models (one of which has the option for a side patio) and two 13ft models which are both 40ft (one of which is a 3 bed). This popular layout is open plan with a central dining position. The sleek low level furniture in the lounge and chunky shelving is minimalistic in style creating a modern look.





Pemberton Marlow 40 x 13 2 bed shown with standard Seafoam Aluminium Cladding & White Windows & Doors



Kitchen highlights include copious storage, white Shaker style doors, a generous counter top and an integrated microwave. Optional upgrades include an accessory pack with cushions and throws, other kitchen appliances and a lift up storage bed for the master bedroom amongst other items. The decor throughout is tasteful and considered focusing on hints of teal to add a splash of colour.

Highlights

- Open plan living area
- Wall mounted flame effect fire with remote control
- Integrated microwave
- Free standing dining table with velour dining chairs
- L shaped sofa incorporating a sofa bed (2 sofas only in the side patio layout)
- Accent chair (not in side patio layout)
- En-suite to master bedroom (toilet & sink)
- Walk-in wardrobe in 36ft 2 bed model
- Integrated cooker with separate oven and grill

36ft x 12ft	2 bedroom
38ft x 12ft	2 bedroom
40ft x 13ft	2 & 3 bedroom

Marlow

Residential Specification

Option includes the following:

- Roof 250mm insulated
- 100mm thick wall
- Floor minimum 65mm insulated
- Windows low E glass and Argon filled
- Superior Insulation U values exceeding the British Standard

- | | |
|--|---|
|  Cooker |  USB Point |
|  Hob |  TV Space |
|  Fridge-Freezer |  Electric Fire |
|  Microwave |  Patio Doors |
|  Washer/Dryer |  French Doors |
|  Dishwasher |  Bifold Doors |
|  Boiler |  Wardrobe |



 **3D Walkthroughs**
available to view online
www.pembertonlh.co.uk

36ft x 12ft - 2 bedroom

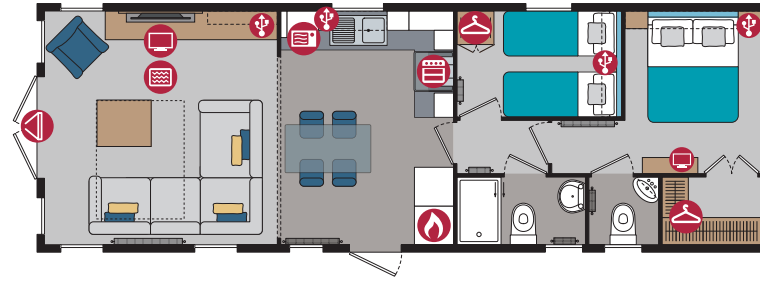

38ft x 12ft - 2 bedroom

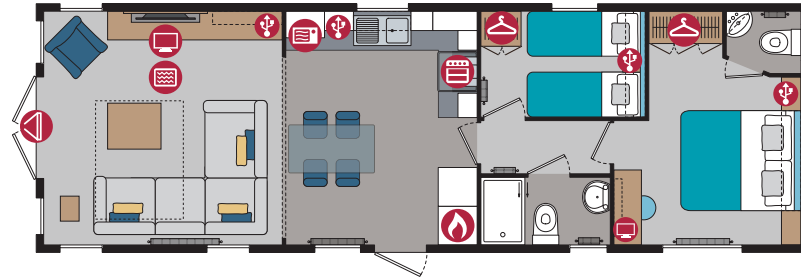

38ft x 12ft - 2 bedroom (Side Patio)

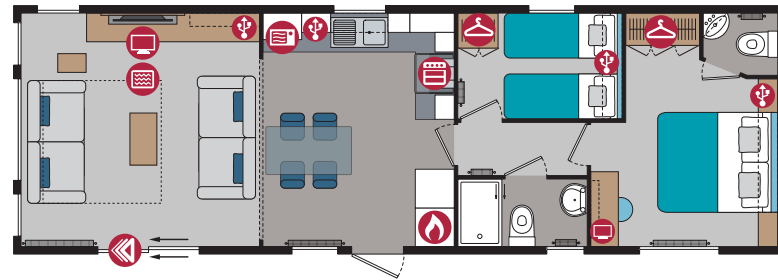

40ft x 13ft - 2 bedroom

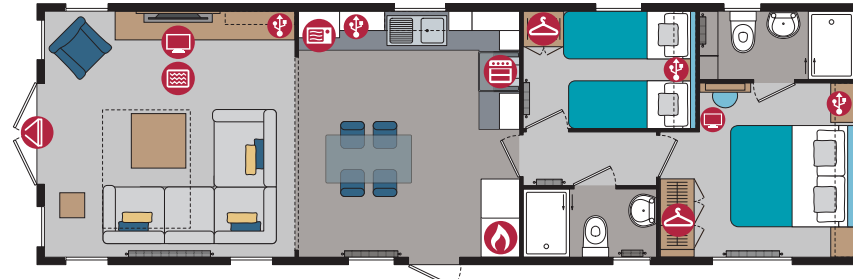

40ft x 13ft - 3 bedroom

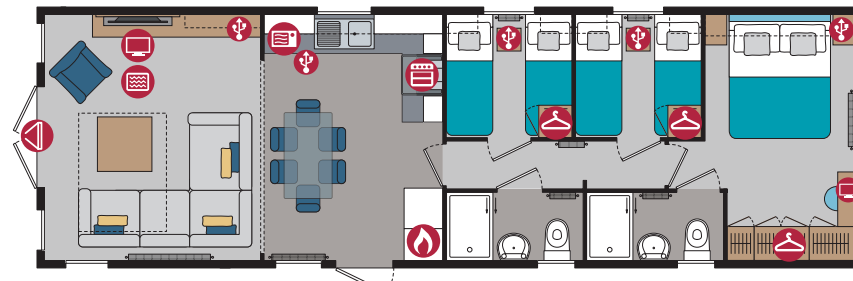



Options available to order

- Residential Specification to BS3632 available in all cladding types
- PVCu double glazing
- Patio or French doors to front or side elevation
- Gas combi central heating system with thermostatic radiator valves
- Pre-galvanised steel chassis
- Integrated dishwasher and washer dryer (except 36ft and 40ft 3 bed which fits a 600mm wide dishwasher or washing machine)
- Intergrated fridge freezer
- TV points in the twin bedrooms
- Lounge curtains instead of venetians
- Stowaway occasional bed in twin room
- Lounge Scatter Cushions
- Bedroom Throws and Co-ordinating Scatter Cushions
- Duvet Sets
- Marlow Lodge available in Grain Effect Plastic and Canexel Cladding
- Lift up storage bed
- All electric version including central heating

For further details see standard features checklist on pages 76-77.

