

Arrondale Lodge

The Arrondale is quite distinctive thanks to its 16 foot dimension as it gives you the lodge feel for a more modest pitch size. No compromises have been made where this is concerned and you will find the same high specification as any other Pemberton lodge. A contemporary treatment has been given to the furniture and the furnishings using cool shades throughout with pops of colour to bring interest.





Pemberton Arrondale 45 x 15 2 bed shown in optional CanExcel Cladding & standard White Windows & Doors



Highlights include a sleek L shaped sofa incorporating not only a sofa bed but storage too, a tower style cabinet housing the fridge/freezer, oven and grill and microwave and tall radiators throughout. There are two layouts available (42ft x 16ft and 45ft x 16) with 2 bedrooms however with the larger footprint there is the option to change the utility room to a single bedroom.

Highlights

- PVCu double glazing with bifold doors to front elevation
- Self contained entrance hallway with integrated storage (45ft only)
- High level cooker with separate oven and grill
- Integrated washer/dryer, fridge/freezer, dishwasher and microwave
- Kitchen island with 2 bar stools
- Luxurious lounge sofa bed with storage, co-ordinating armchairs and a footstool
- Recessed electric fire and DVD unit
- Full size bath with aqua board
- Large domestic shower in en-suite
- 5ft upholstered divan in the master bedroom with lift up flap for storage
- Vaulted ceiling throughout with a minimum ceiling height of 2.4m (8ft)
- Grain Effect Plastic Cladding
- External socket
- Gas combi central heating system with thermostatic radiator valves
- TV points in all bedrooms
- Glass top dining table
- Wireless thermostat
- Lounge Scatter Cushions
- Bedroom Throws and Co-ordinating Scatter Cushions
- Duvet Sets

42ft x 16ft

2 bedroom

45ft x 16ft

2 & 3 bedroom





Arrondale Lodge





Platinum Package Option includes the following:

- Aggregate Coated Steel Tile System with a 40 Year Weatherproof Warranty
- Wood effect Panelled Ceiling
- Wallpaper Finish
- Domestic Skirting and Door Casings
- Electric Combination Safe
- Hive Heating System
- Wine Cooler
- Bluetooth Speakers
- Outdoor Tap

Residential Specification

Option includes the following:

- Roof 250mm insulated
- 100mm thick wall
- Floor minimum 65mm insulated
- Windows low E glass and Argon filled
- Superior Insulation U values exceeding the British Standard

- | | |
|--|--|
|  Cooker |  USB Point |
|  Hob |  TV Space |
|  Fridge-Freezer |  Electric Fire |
|  Microwave |  Patio Doors |
|  Washer/Dryer |  French Doors |
|  Dishwasher |  Bifold Doors |
|  Boiler |  Wardrobe |



42ft x 16ft - 2 bedroom

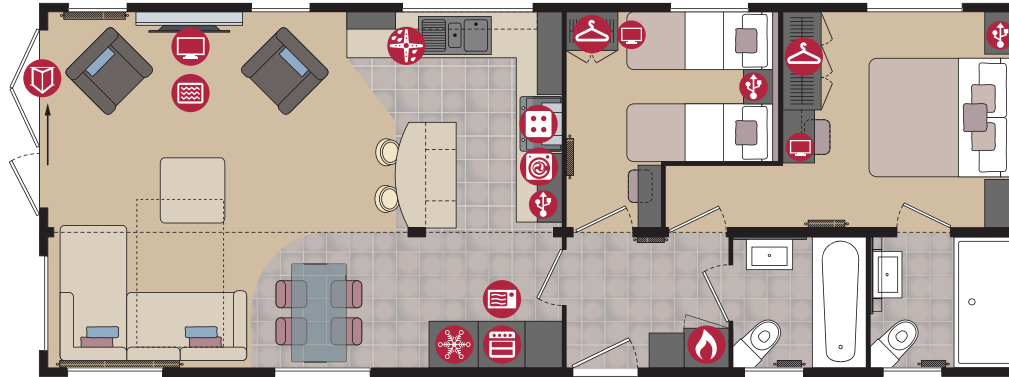

45ft x 16ft - 2 bedroom

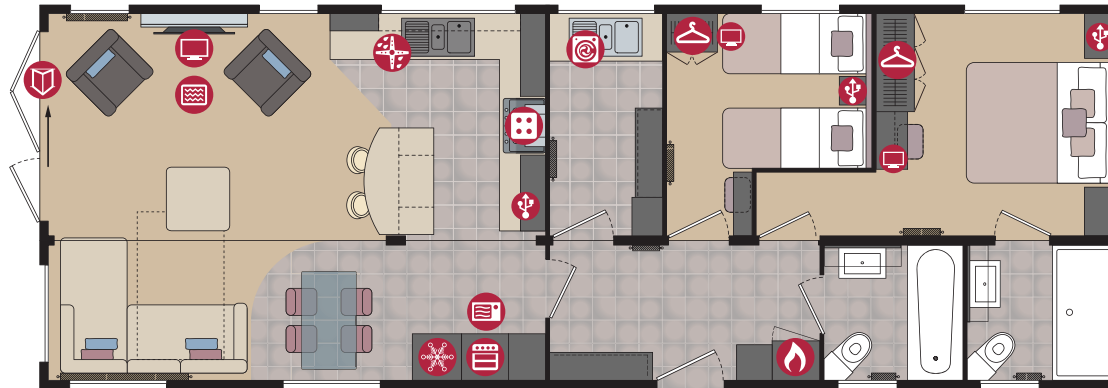

45ft x 16ft - 3 bedroom

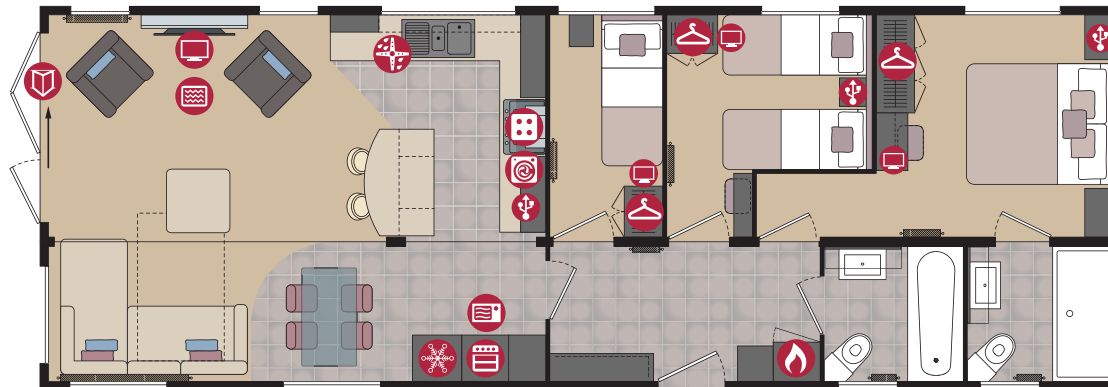



Options available to order

- Residential Specification to BS3632 available in all cladding types
- Wine cooler
- Utility room or single bedroom (45ft only)
- Lounge curtains in lieu of roman blinds
- Shower in lieu of bath
- Stowaway occasional bed in twin room
- Platinum Package
- Arrondale Lodge available in Canexel Cladding
- Lift up storage bed
- All electric version including central heating

For further details see standard features checklist on pages 76-77.



Pemberton
PARK & LEISURE HOMES